

# Town of Rocky Mountain House

## WINTER MAINTENANCE POLICY PRIORITIES MAP (SCHEDULE 'A')



### LEGEND

-  1. DOWNTOWN CORE & 47 AVENUE
-  2. HIGHWAY 11 SERVICE ROADS
-  3. SCHOOL ZONES
-  4. REMAINING MAJOR ROUTES  
(54 STREET, 61 AVENUE, 59 AVENUE,  
50 AVENUE)
-  5. 42 AVENUE, 51 AVENUE, 53 AVENUE,  
46 STREET & 48 STREET
-  6. INDUSTRIAL AREAS
-  7. MCNUTT SUBDIVISION, 42 AVENUE  
& 42 STREET
-  8. TOWN OFFICE, SWIMMING POOL, ARENA,  
COMMUNITY CENTRE & MUSEUM
- 9. REMAINING RESIDENTIAL AREAS &  
PIONEER CENTRE

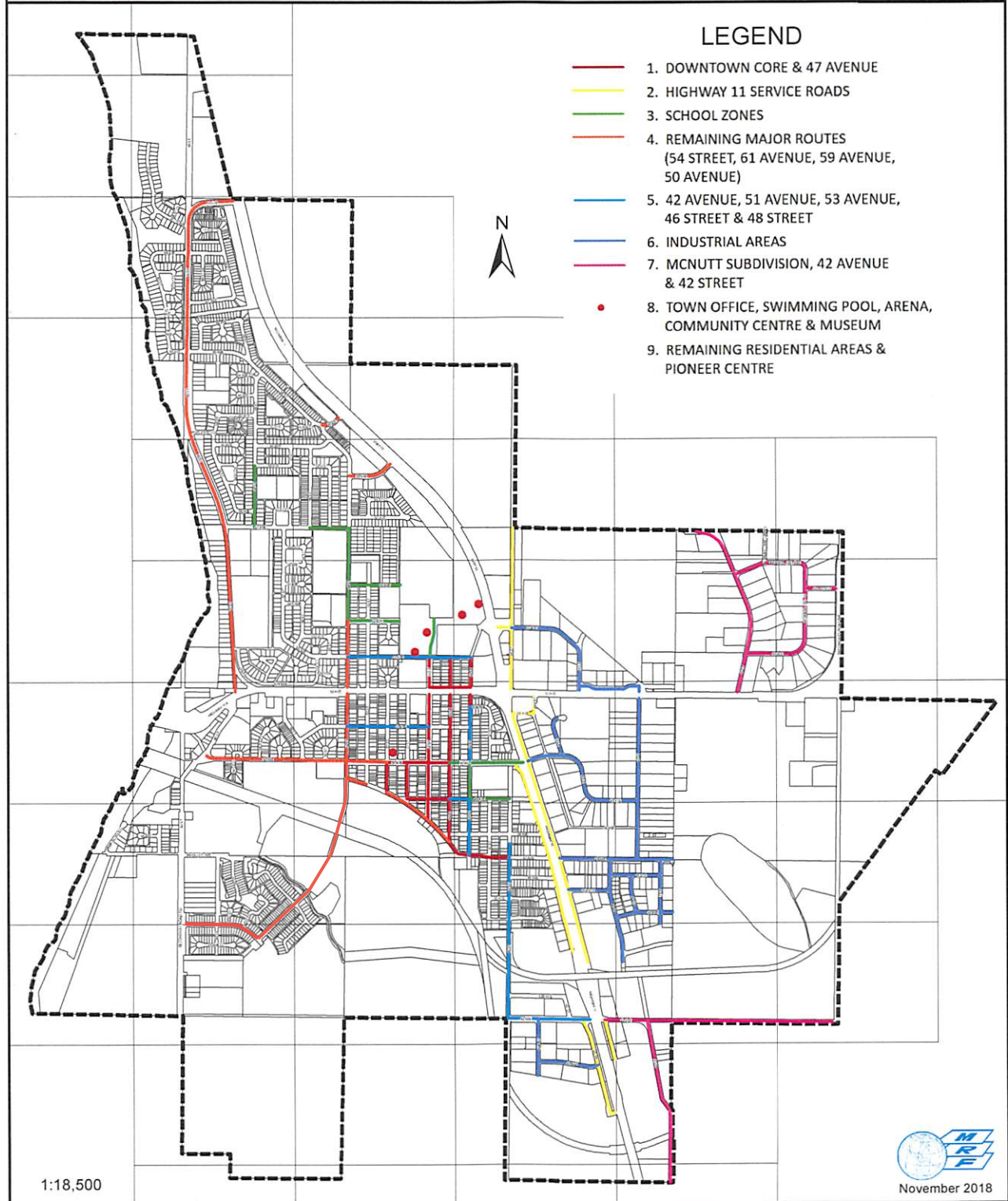

1:18,500

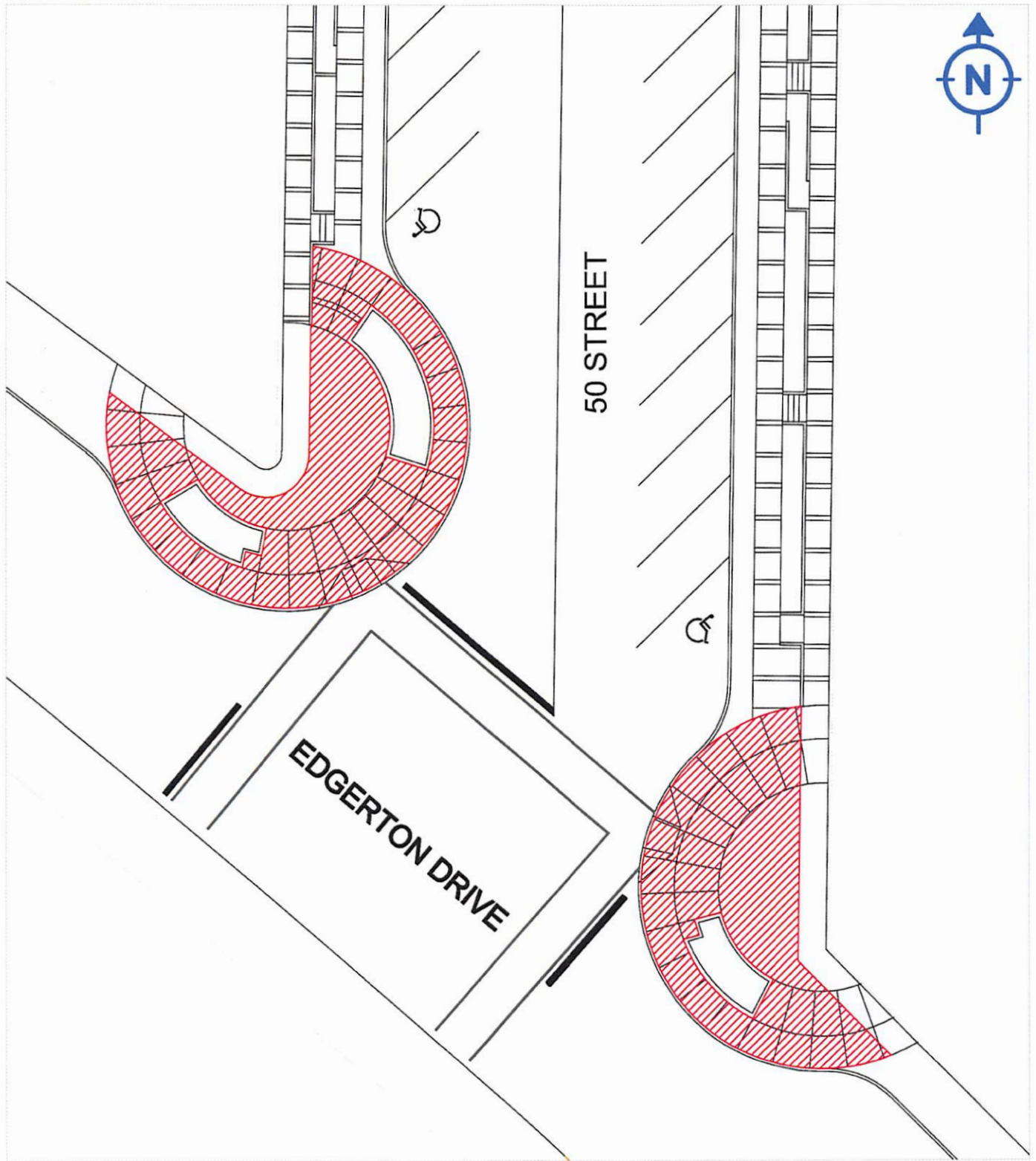

TOWN TO CLEAR SIDEWALK

DATE: DECEMBER 2, 2014



FIGURE NO.

B.1

ROADWAY WINTER MAINTENANCE POLICY  
50 STREET INTERSECTION BULBOUTS  
SNOW CLEARING

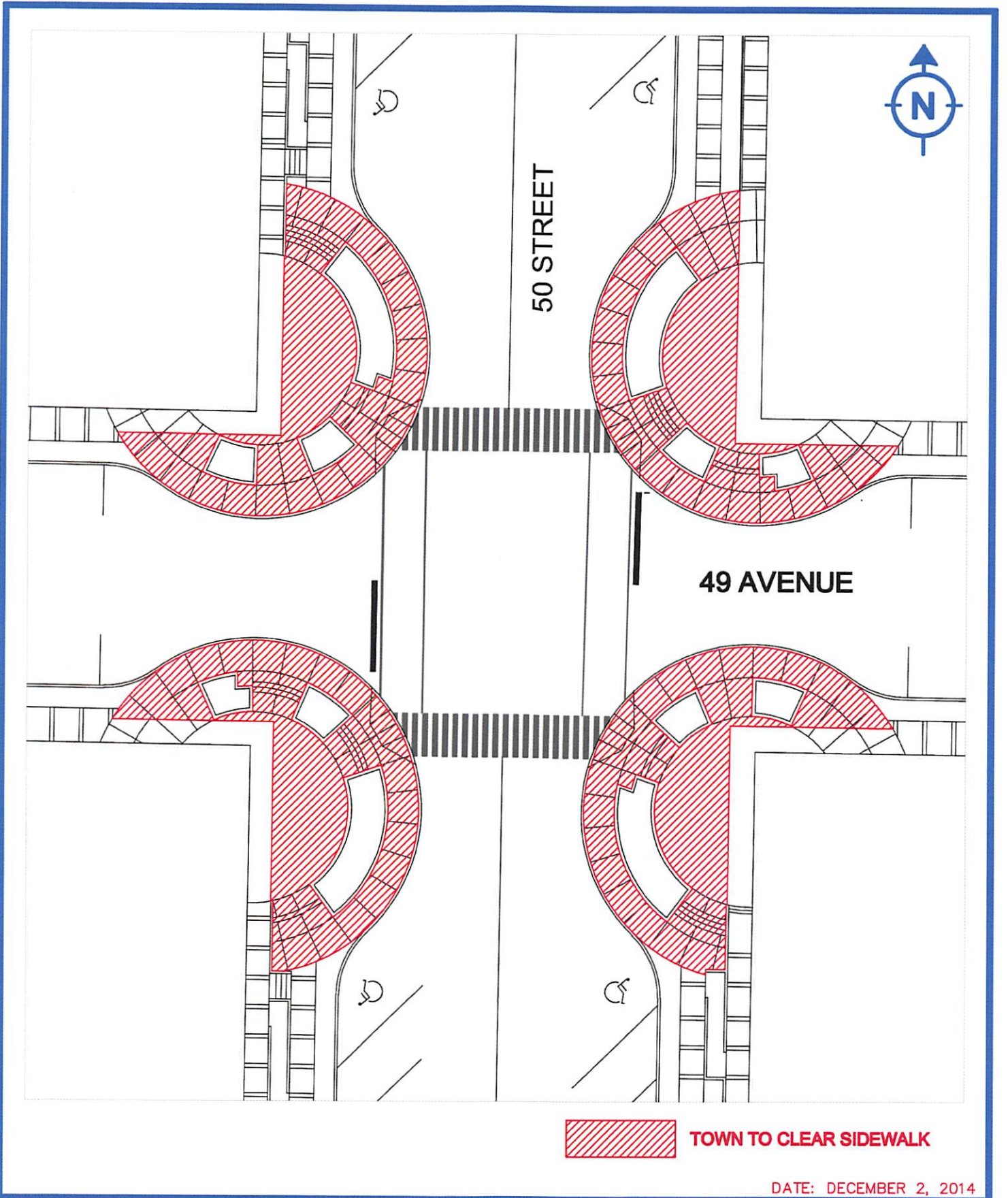

DATE: DECEMBER 2, 2014



FIGURE NO.  
B.2

ROADWAY WINTER MAINTENANCE POLICY  
50 STREET INTERSECTION BULBOUTS  
SNOW CLEARING

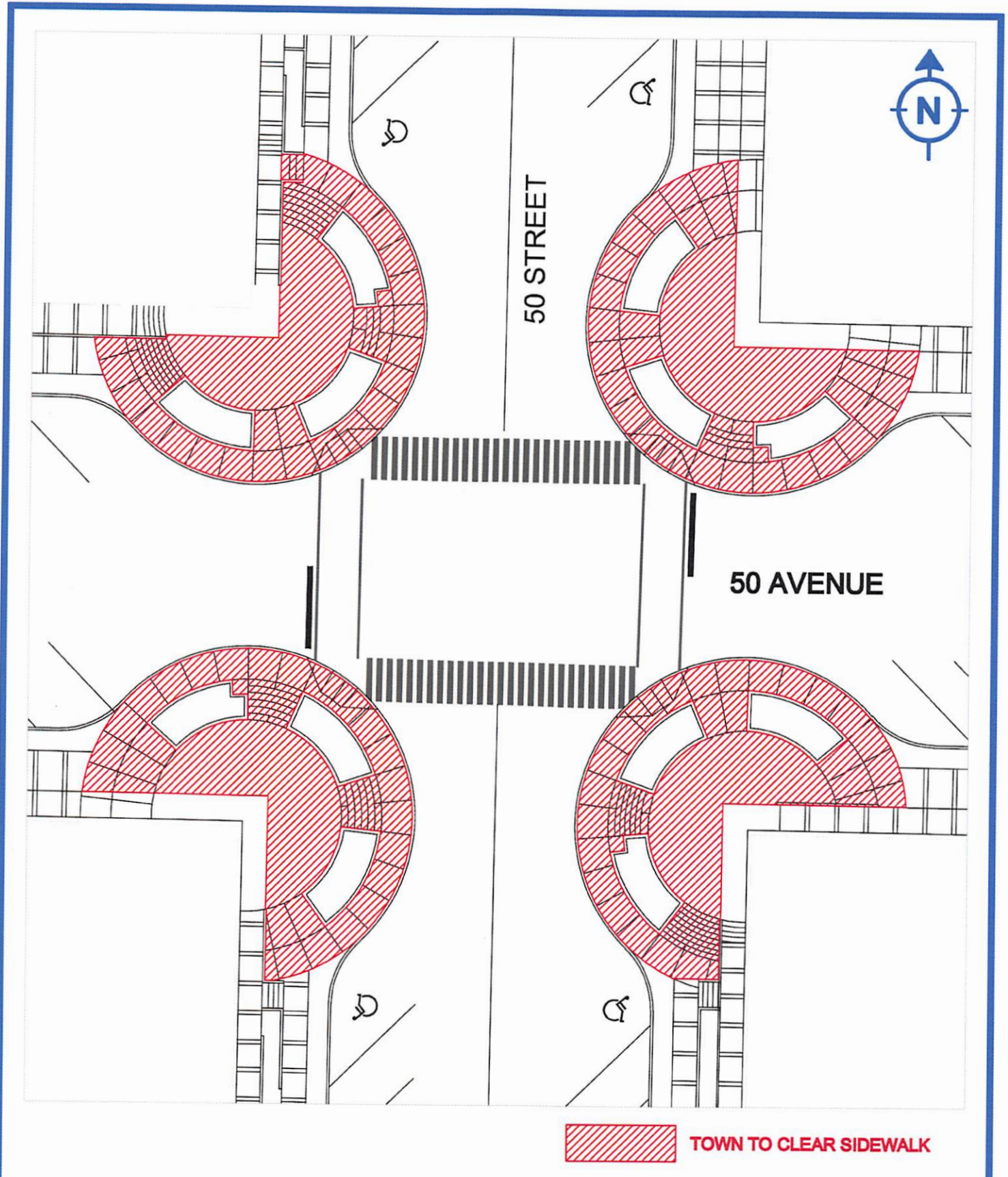

 TOWN TO CLEAR SIDEWALK

DATE: DECEMBER 2, 2014



FIGURE NO.  
**B.3**

**ROADWAY WINTER MAINTENANCE POLICY**  
**50 STREET INTERSECTION BULBOUTS**  
**SNOW CLEARING**

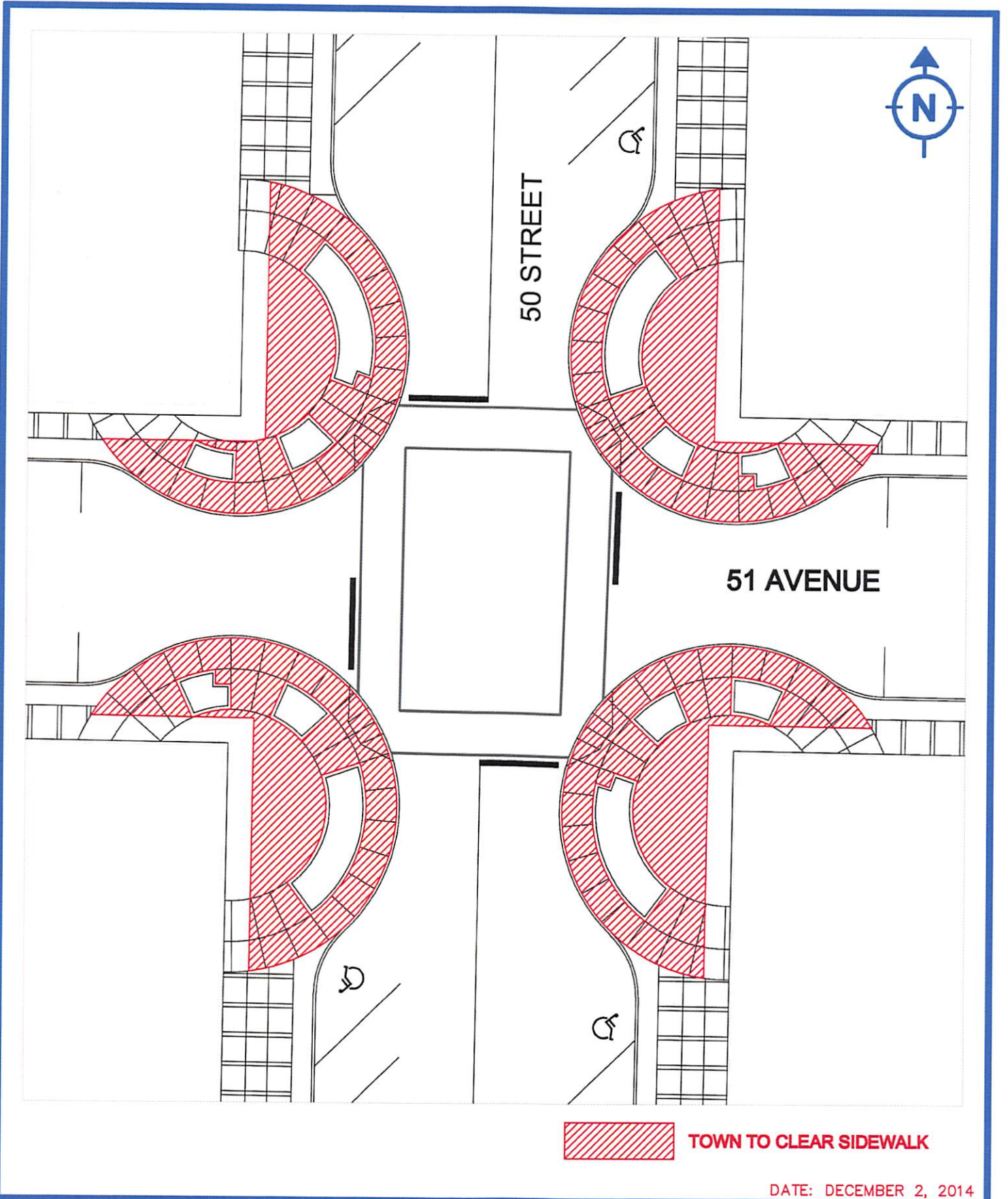

 TOWN TO CLEAR SIDEWALK

DATE: DECEMBER 2, 2014



FIGURE NO.  
B.4

ROADWAY WINTER MAINTENANCE POLICY  
50 STREET INTERSECTION BULBOUTS  
SNOW CLEARING

52 AVENUE

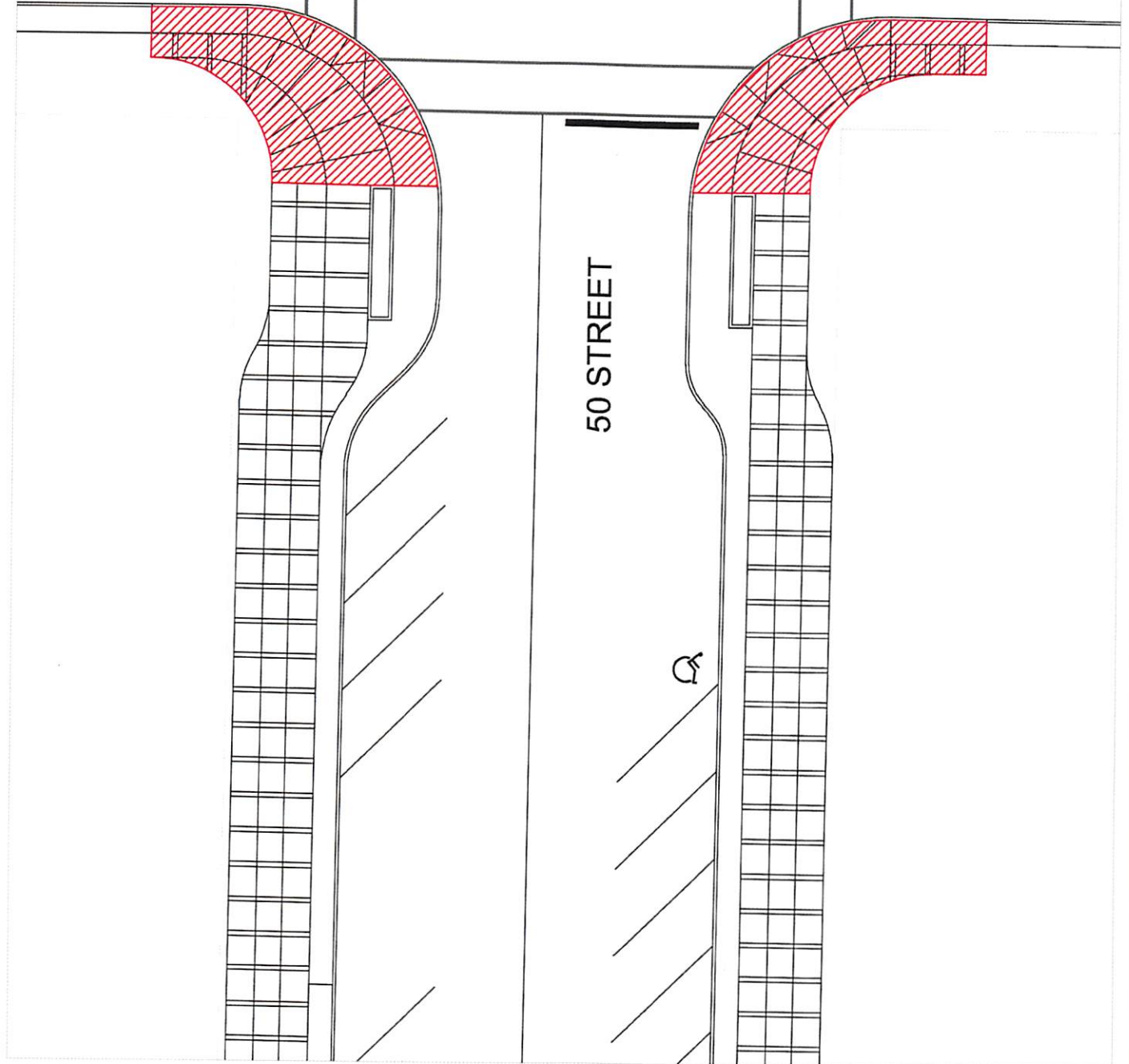

50 STREET



TOWN TO CLEAR SIDEWALK

DATE: DECEMBER 2, 2014



FIGURE NO.

B.5

ROADWAY WINTER MAINTENANCE POLICY

50 STREET INTERSECTION BULBOUTS

SNOW CLEARING